



# SOATOER

AN ISO 9001 APPROVED COMPANY

## XL-3

**VOLUMETRIC METERING VALVES  
FOR OIL AND GREASE OPERATION**  
用于润滑油和润滑脂操作的容积计量阀



General information 基本信息	3
Operation 操作	4
Adjustment 调节	5
System structure 系统结构	6
Valves for Distributor 分配阀	7
Spare parts 备件	8



All SOATOER products must only be used for their intended purposes, as specified in this brochure and in all instructions. If the product is supplied together with user instructions, the user is required to read them and comply with them. Not all lubricants are suitable for centralised lubrication systems. SOATOER lubrication systems or relative components cannot be used together with gas, liquid gas, pressurised gas in solution and liquids with vapour pressure exceeding normal atmospheric pressure (1013 bar) by more than 0.5 bar, maximum temperature permitted. Any type of dangerous materials, namely those classified as such by European Community Directive (EC) 67/548/EEC, Article 2 (2), can only be used in SOATOER centralised lubrication systems or relative components upon consultation with SOATOER and after having received written approval from the company.

所有SOATOER产品只能用于本手册和所有说明书中规定的目的。如果产品与用户说明一起提供，用户被要求阅读并遵守它们。并不是所有的润滑油都适合集中润滑系统。SOATOER润滑系统或相关部件不能与气体、液化气、溶液中的加压气体和蒸汽压力超过正常大气压(1013巴)0.5巴(允许的最高温度)的液体一起使用。任何类型的危险材料，即欧共体指令(EC) 67/548/EEC第2(2)条规定的危险材料，只有在与SOATOER协商并获得公司的书面批准后，才能用于SOATOER集中润滑系统或相关组件。

### General information 基本信息

The lubricant delivery units are manually, pneumatically or electrically actuated and the lubricant is metered out by means of the metering valves installed in the tubing system. The metering valves are produced with different discharges to supply every lubrication point with the requisite amount of lubricant per stroke or pump work cycle. It is absolutely necessary to use a perfect clean lubricant for a correct valve operation.

润滑剂输送单元是手动、气动或电动驱动的，润滑剂通过安装在管道系统中的计量阀进行计量。计量阀具有不同的排放量，可为每个润滑点提供每个冲程或泵工作循环所需的润滑剂量。绝对有必要使用完美清洁的润滑剂来正确操作阀门。

### Applications 应用

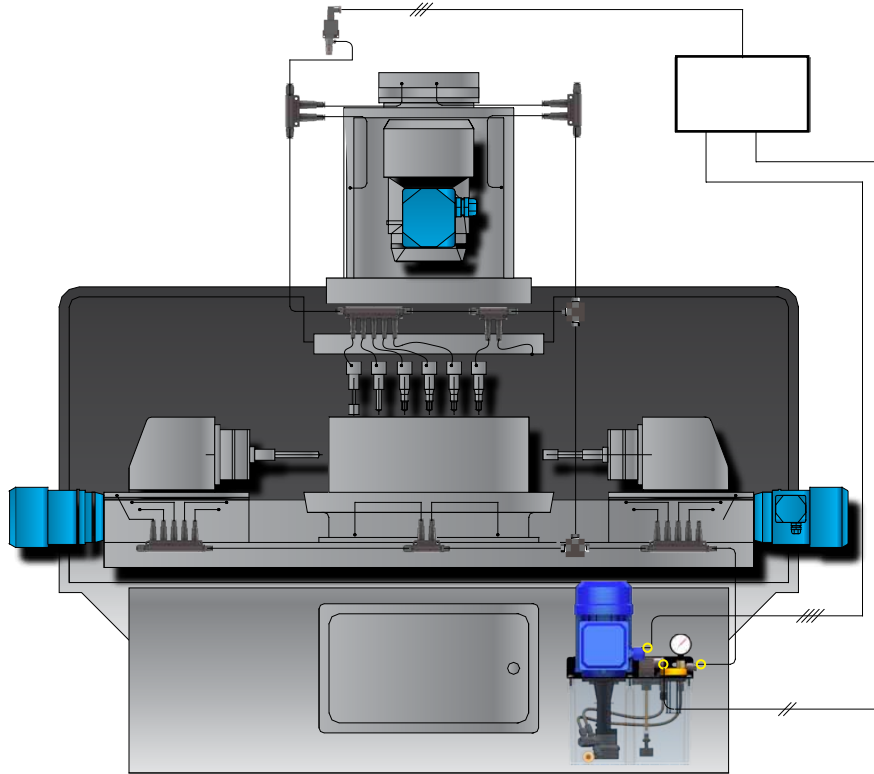

### Technical data 技术参数

Lubricants 润滑剂	Oil 32 cSt – 2000 cSt	Grease NLGI0
Working pressure Bar [PSI] (min-max) 最大最小工作压力	12 [175] - 50 [725]	
Flow rate (min-max) 最大最小流量	0.03ml [.131] - 0.5ml [1.31]	
Release pressure Bar [PSI] 释放压力	3 [46]	
Temperature 温度	from -30 °C to +150 °C	
Seals 密封	VITON	
Block inlet 底座进口螺纹	1/8" G (F)	
Valve output 阀出口螺纹	1/8" G (F)	
Valve Material 阀材料	Steel or SS316L	
Distributor material 分配器材料	Aluminum or SS316L	

*Important: the data provided above are theoretical and subject to variation based on the extension of the system, the size of the main pipe, the type of lubricant used and the working temperature.*

重要:上面提供的的数据是理论的,并且会根据系统的扩展、管道的尺寸、使用的润滑剂的类型和工作温度而有所变化。

XL-3

Valves 阀

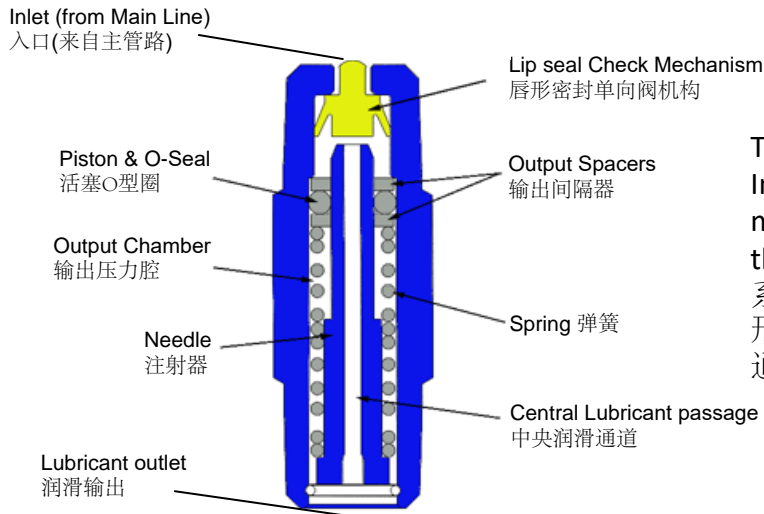

The system is pressurized and oil flows into the Inlet side of the injector. The Lip seal check mechanism allows oil to flow past blocking off the Central Lubricant Passage.

系统被加压，油流入喷油器的入口侧。唇形密封检查机构允许油流过阻塞中央润滑油通道。

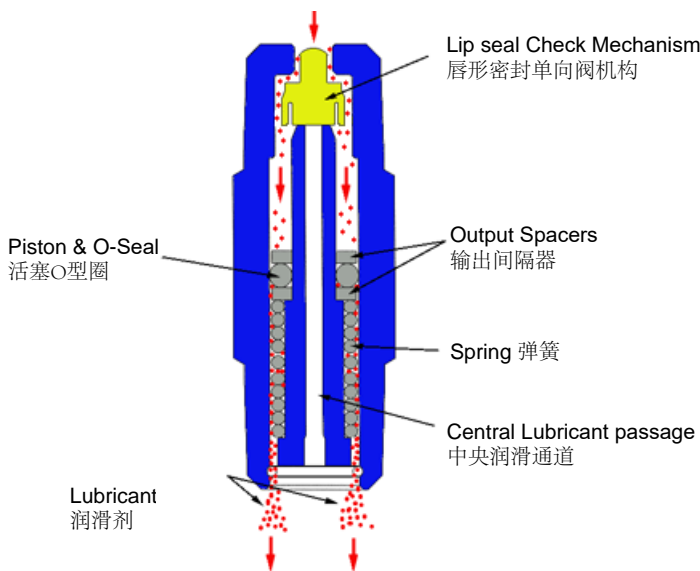

Lubricant enters the upper chamber of the injector which causes the Piston & O-Seal to move downwards pushing the oil accumulated in the Output chamber (from the previous cycle) towards the lubrication point.

润滑剂进入喷油器的上腔，导致活塞和 O 型密封件向下移动，将积聚在输出腔（来自上一个循环）中的油推向润滑点。

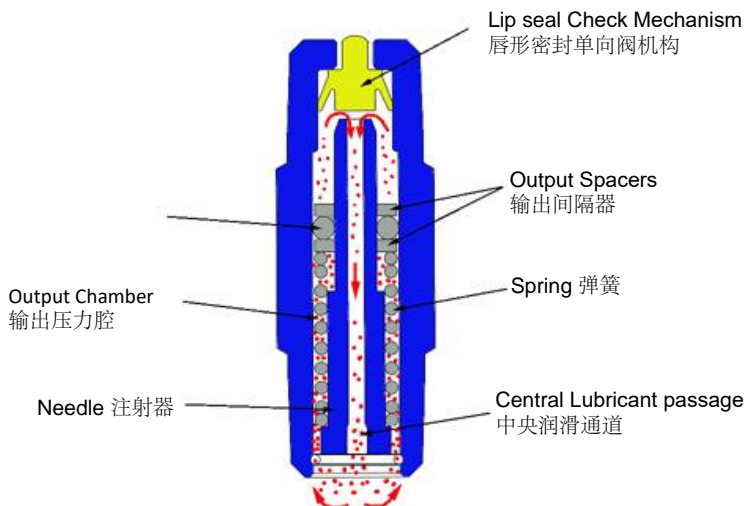

The final stage occurs when Pressure is released from the Inlet resetting the injector. During this phase the Spring pushes the piston & O-Seal back upwards, together with the check mechanism that permits the lubricant to flow across the Central Lubricant Passage and back into the Output Chamber, ready for the next lubrication cycle.

最后阶段发生在从重置喷油器的入口释放压力时。在此阶段，弹簧将活塞和 O 型密封件向上推回，以及允许润滑剂流过中央润滑剂通道并返回输出室的止回机构，为下一个润滑周期做好准备。

XL-3

Valves assemble 阀组

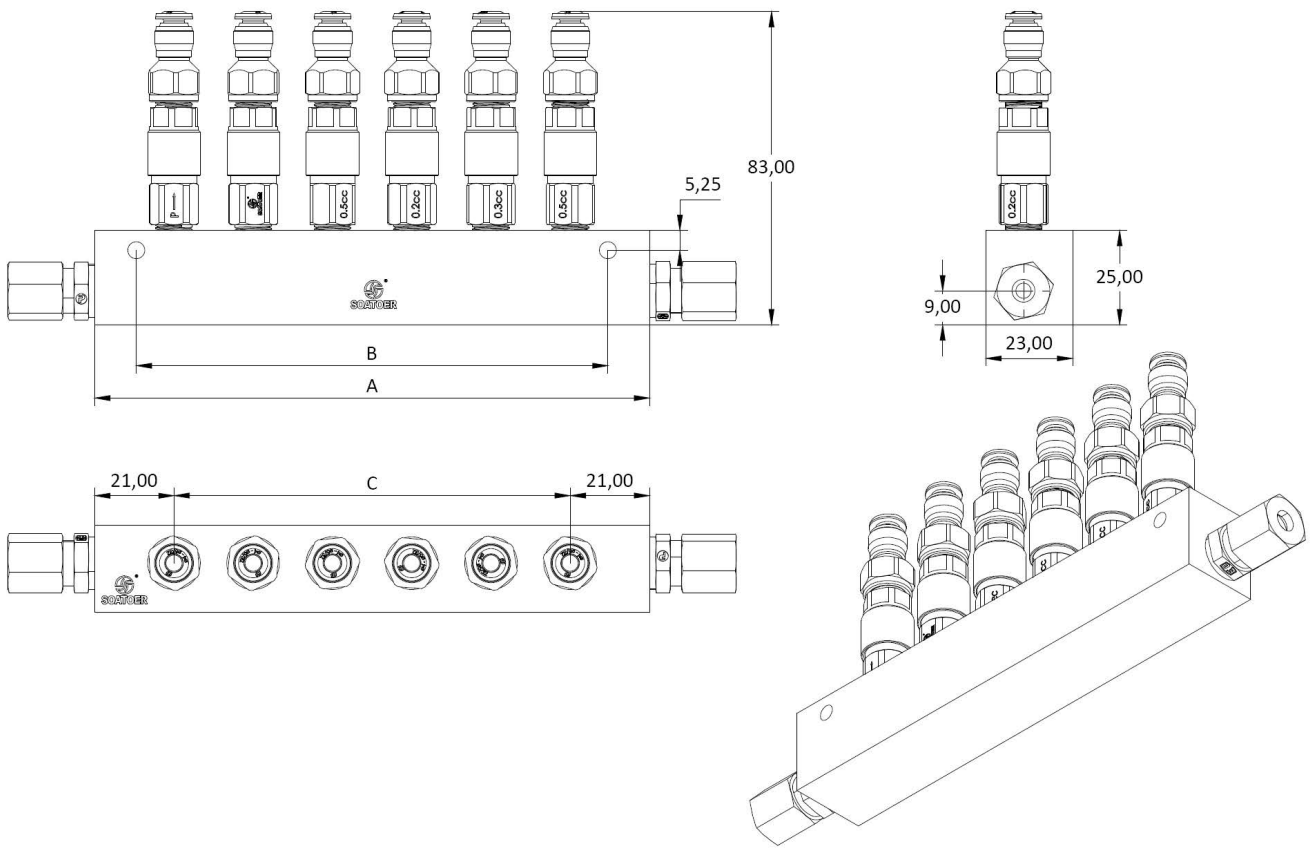

Outlet Ports 输出口	Part Number 型号	Dimensions 尺寸			Weight 重量
		A	B	C	
1	3071311	42	20		30
2	3071312	63	41		63
3	3071313	84	62		96
4	3071314	105	83		120
5	3071315	126	104		146
6	3071316	147	125		169

XL-3

Valves assemble 阀组

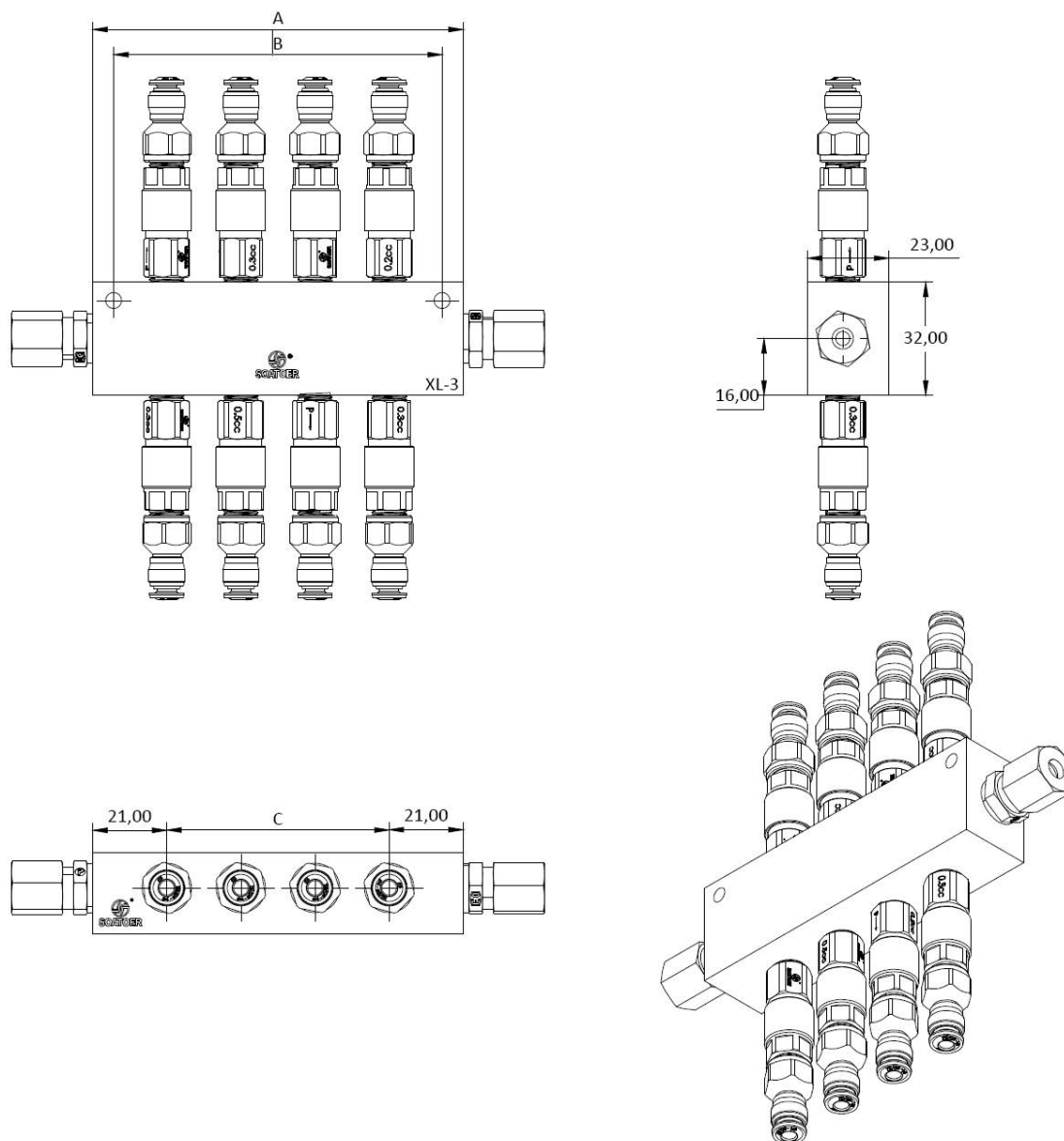

Outlet Ports 输出口	Part Number 型号	Dimensions 尺寸			Weight 重量
		A	B	C	
1	3071311	42	20		30
2	3071312	63	41		63
3	3071313	84	62		96
4	3071314	105	83		120
5	3071315	126	104		146
6	3071316	147	125		169

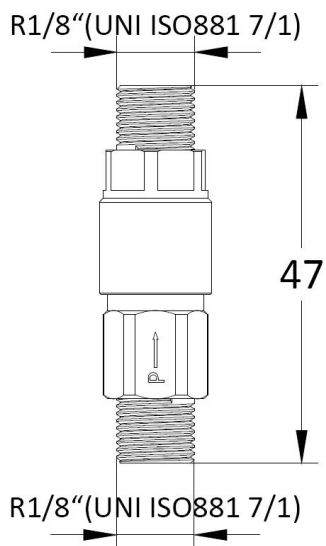

Code	Output/Cycle	Materials	Code	Output/Cycle	Materials
6021101	0.03cc	Nickel steel	6021201	0.03cc	SS316L
6021102	0.06cc	Nickel steel	6021202	0.06cc	SS316L
6021103	0.10cc	Nickel steel	6021203	0.10cc	SS316L
6021104	0.16cc	Nickel steel	6021204	0.16cc	SS316L
6021105	0.20cc	Nickel steel	6021205	0.20cc	SS316L
6021106	0.30cc	Nickel steel	6021206	0.30cc	SS316L
6021107	0.50cc	Nickel steel	6021207	0.50cc	SS316L

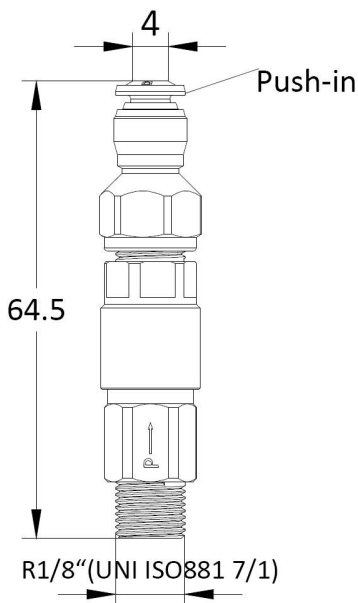

Code	Output/Cycle	Materials	Code	Output/Cycle	Materials
6021301	0.03cc	Nickel Steel	6021401	0.03cc	SS316L
6021302	0.06cc	Nickel Steel	6021402	0.06cc	SS316L
6021303	0.10cc	Nickel Steel	6021403	0.10cc	SS316L
6021304	0.16cc	Nickel Steel	6021404	0.16cc	SS316L
6021305	0.20cc	Nickel Steel	6021405	0.20cc	SS316L
6021306	0.30cc	Nickel Steel	6021406	0.30cc	SS316L
6021307	0.50cc	Nickel Steel	6021407	0.50cc	SS316L

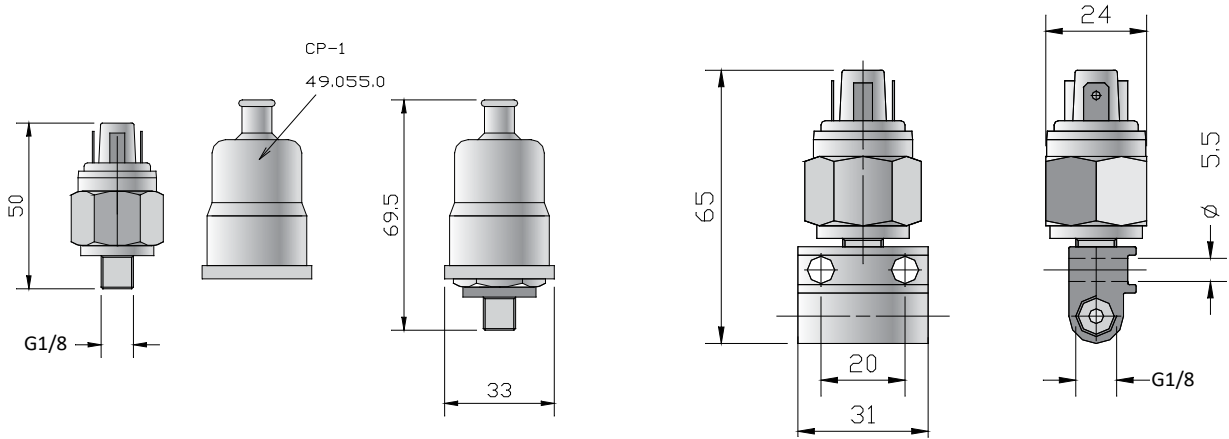

FEATURES

OPERATING VOLTAGE	250 V AC
OPERATING POWER	100 V A
CURRENT INTENSITY	0.5A RESIS. 0.25A INDUT.
OPERATING TEMPERATURE	-5 °C +60 °C
ENCLOSURE	IP 54
MAXIMUM STROKES	200/1'
ISOLATING VOLTAGE	1500 V

CODES FOR ORDER PRESSURE SWITCH

1500 V

CODE	TYPE NO	BAR	CODE	TYPE NC	CODE	TYPE NO	BAR	CODE	TYPE NC
49.061.0	PMN	2A	49.062.0	PMN	2C	49.063.0	330	49.064.0	PMN
49.061.1	PMN	10A	49.062.1	PMN	10C	49.063.1	355	49.064.1	PMN
49.061.2	PMN	20A	49.062.2	PMN	20C	49.063.2	330	49.064.2	PMN
49.061.3	PMN	50A	49.062.3	PMN	50C	49.063.3	355	49.064.3	PMN
49.061.4	PMN	80A	49.062.4	PMN	80C	49.063.4	330	49.064.4	PMN
49.061.5	PMN	150A	49.062.5	PMN	150C	49.063.5	355	49.064.5	PMN
49.061.6	PMN	250A	49.062.6	PMN	250C	49.063.6	330	49.064.6	PMN



XL-3

Valves Base 阀底座

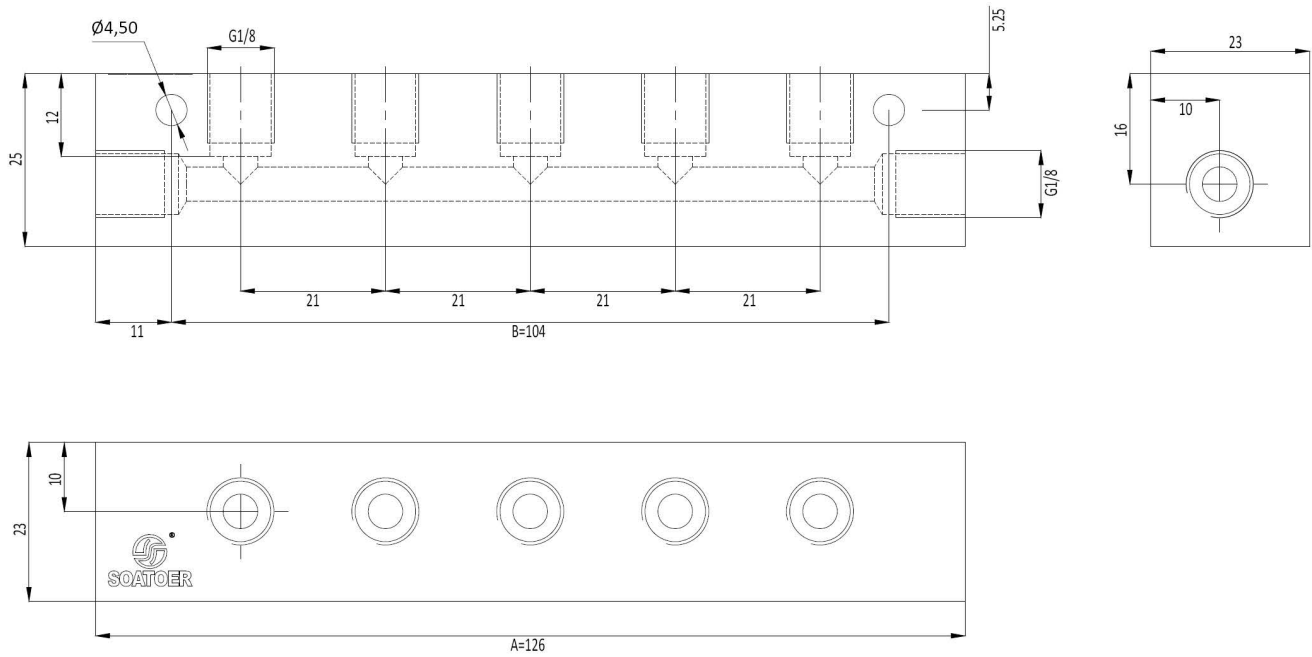

Code	Output/Cycle	Materials	Code	Output/Cycle	Materials
9302153	1	Alumina	9302173	1	SS316L
9302154	2	Alumina	9302174	2	SS316L
9302155	3	Alumina	9302175	3	SS316L
9302156	4	Alumina	9302176	4	SS316L
9302157	5	Alumina	9302177	5	SS316L
9302158	6	Alumina	9302178	6	SS316L

XL-3

Valves Base 阀底座

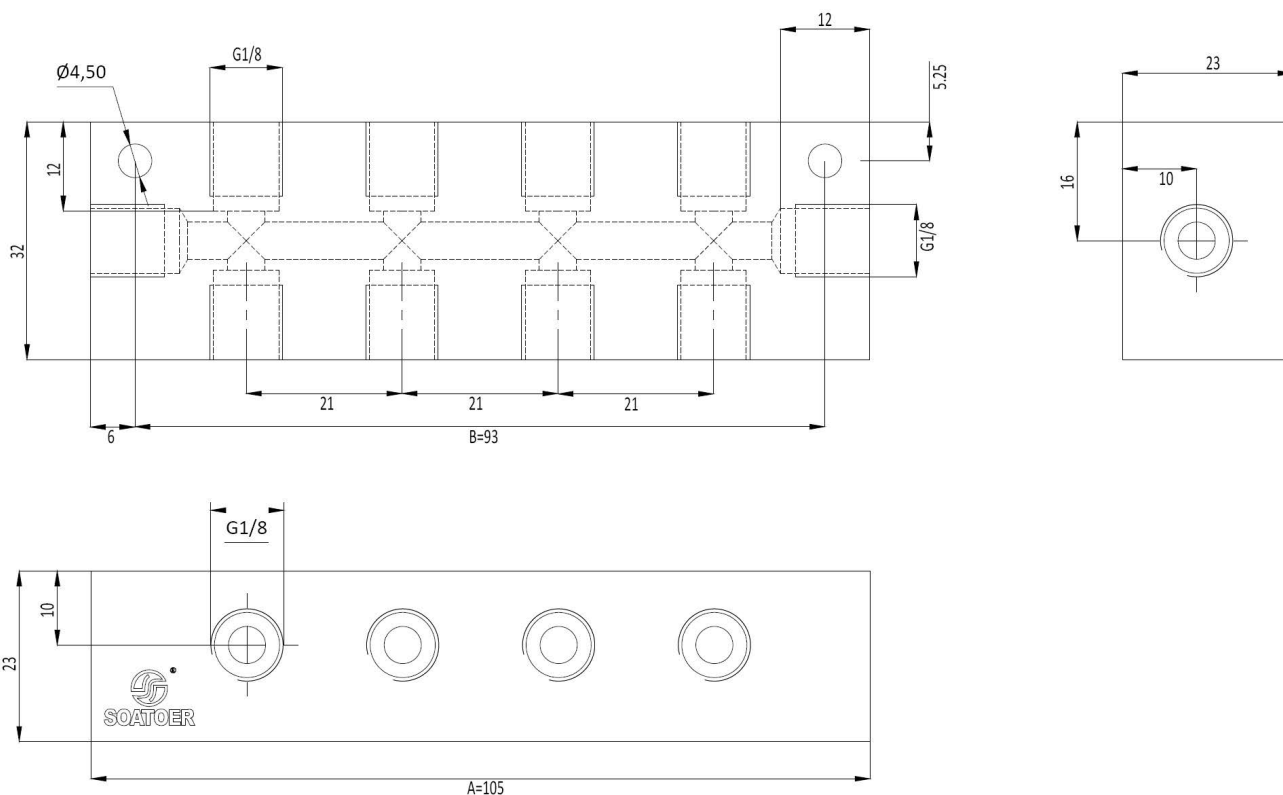

Code	Output/Cycle	Materials	Code	Output/Cycle	Materials
9302164	2	Alumina	9302184	2	SS316L
9302165	4	Alumina	9302185	4	SS316L
9302166	6	Alumina	9302186	6	SS316L
9302167	8	Alumina	9302187	8	SS316L

Soatoer Fluid System (Shanghai) Co.,Ltd -201612- Songjiang Shanghai -China

Phone +86 21 54888200 - Fax +86 21 54888020 - [www.soatoer.com](http://www.soatoer.com) - [sales@soatoer.com](mailto:sales@soatoer.com)